

Part Number: 00016-60009

Accessory Code:



**Kit Contents**

Item #	Quantity Req'd.	Description
1	1	Bazooka Tube Assembly
2	1	Wire Harness
3	1	Hardware Bag
4	1	Care Card

**Hardware Bag Contents**

Item #	Quantity Req'd.	Description
1	4	4" Wire Ties
2	4	M6 X 30mm Bolts
3	2	M6 X 25mm Bolts
4	2	Main Plate w/ mounts
5	2	L- Mounting Plates
6	4	M6 X 30mm Bolts
7	2	Washers

**Additional Items Required For Installation**

Item #	Quantity Req'd.	Description
1		

**Conflicts**

None
------

**Recommended Tools**

Personal & Vehicle Protection	Notes
Vehicle Protection	Seat/Floor Covers
Part Protection	Blankets
Special Tools	Notes
Installation Tools	Notes
Panel Removal Tool	Nylon Removal Tool (NRT)
Socket/Ratchet	10mm
Socket Extension	6 inch
Torque Wrench	3 lbf-ft
Pliers	1. Diagonal Cutters 2. Long Nose (optional)
Screwdriver	Magnetized Philips # 2
Special Chemicals	

**General Applicability**

All Toyota FJ Grades
----------------------

**Recommended Sequence of Application**

Item #	Accessory
1	Install Security/Audio
2	Install Bazooka Tube
3	Install Door Sills
4	Install Molded Dash

\*Mandatory

**Vehicle Service Parts** (may be required for reassembly)

Item #	Quantity Req'd.	Description
1		

**Bass Tube Specifications**

Woofer Size	8"
Voice Coil Size	1"high power/high temp.
Magnet Size	15 oz.
Frequency Response	39 – 85 hz.
Efficiency	105dB
Power Handling	100 watts
Dimensions	18.125" x 8.5" x 10"
Weight	14 lbs.
Impedance	2 ohms DVC

**Legend**

	<b>STOP:</b> Damage to the vehicle may occur. Do not proceed until process has been complied with.
	<b>OPERATOR SAFETY:</b> Use caution to avoid risk of injury.
	<b>CAUTION:</b> A process that must be carefully observed in order to reduce the risk of damage to the accessory/ vehicle and to ensure a quality installation.
	<b>TOOLS &amp; EQUIPMENT:</b> Used in Figures calls out the specific tools and equipment recommended for this process.
	<b>REVISION MARK:</b> This mark highlights a change in installation with respect to previous issue.

**SPECIAL NOTE: Installation Sequences**

After TMS and Safety mandated preparatory steps have been taken, the installation sequence is the suggested method for completing the accessory installation. In some instances the suggested sequence is written for one associate to install and in others the sequence is given as part of a team accessory installation. Unless otherwise stated in the document, the associates may perform the installation steps in any order to make the installation as efficient as possible while maintaining consistent quality.

Care must be taken when installing this accessory to ensure damage does not occur to the vehicle. The installation of this accessory should follow approved guidelines to ensure a quality installation.

These guidelines can be found in the "Accessory Installation Practices" document.

This document covers such items as:-

- Vehicle Protection (use of covers and blankets, cleaning chemicals, etc.).
- Safety (eye protection, rechecking torque procedure, etc.).
- Vehicle Disassembly/Reassembly (panel removal, part storage, etc.).
- Electrical Component Disassembly/Reassembly (battery disconnection, connector removal, etc.).

Please see your Toyota dealer for a copy of this document.

## 1. Pre-installation Precautions



- (a) Use Seat & Floor Protectors and Fender Covers/Blankets to avoid damage to surfaces. Operator Safety Warning (if applicable.)

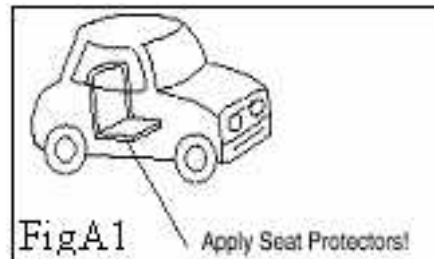

## Battery Disconnect

- (a) NOTE: Be sure to open the rear hatch, PRIOR to disconnecting the battery.
- (b) Remove the NEGATIVE (-) battery terminal using a 10mm socket before any disassembly starts. (Fig. 2-1).



## 3. Disassemble Center Rear Storage Area

- (a) Remove Cargo Net Cleats using 10mm Socket. Place in a safe location.
- (b) Remove Side Trim Cover, Quarter Trim Pocket, Quarter Trim Pocket Tray. (Fig. 3-2)

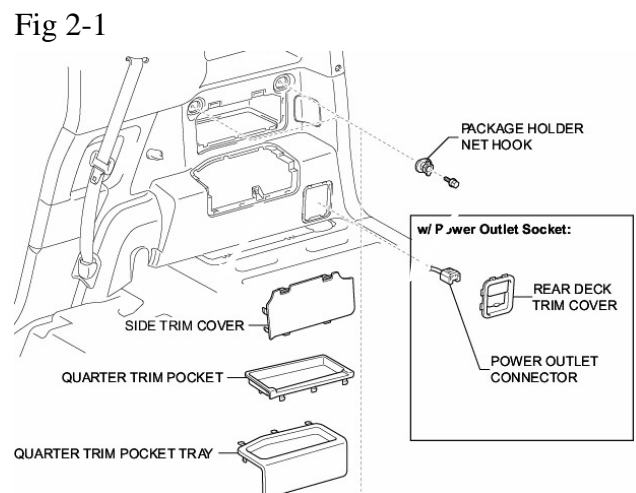

Fig 3-2

**4. Mount L-Brackets**

- (a) On wheel well, slide L-brackets under side garnish ensuring no wires are pinched. Insert Ground ring between front L-bracket and vehicle. **DO NOT TIGHTEN AT THIS POINT!** (Fig. 4-1)

NOTE: It may be necessary to unsnap factory harness clip to align rear L-bracket.



Fig. 4-1

**5. Route Wire Harness**

- (a) Plug harness in at point shown. (Fig. 5-1)
- (b) Route Wire harness as shown. (Fig. 5-2)
- (c) Secure Wire harness at regular intervals using 4" wire ties.



Fig 5-1



(1) Fig. 5-2

## 6. Install Main Plate

- (a) Using the Cargo Cleats and the M6 x 35mm, loosely mount the top of the main plate. **DO NOT TIGHTEN AT THIS POINT!** See Fig 6-1.
- (b) Route wiring harness through slot in Main plate as shown. (Fig 6-2)
- (c) Using two M6 x 20mm bolts and a washer, bolt the lower points of the main plate to the L-Brackets. **DO NOT TIGHTEN AT THIS POINT!** (Fig. 6-3)



Fig 6-1



Fig 6-2

## 7. Tighten All Bolts

- (a) Tighten bottom L-bracket bolts.
- (b) Tighten Cargo cleat bolts.
- (c) Tighten Main Plate bolts to L-brackets.



Fig 6-3

**8. Install Bass Tube**

- (a) Hang Bass Tube on Main Mounting Plate as shown
- (b) Using two M6 x 20MM bolts, tighten down upper bolts as indicated in Fig 8-4.
- (c) Plug Harness Connector into Bass Tube.



Fig 8-4

<u>Check:</u>	<u>Look For:</u>
<p><b><u>Accessory Function Checks</u></b></p> <p><input type="checkbox"/> Turn on Radio</p> <p><input type="checkbox"/> Verify CD &amp; Satellite Tuner (if equipped)</p> <p><input type="checkbox"/> Antenna is functioning</p> <p><input type="checkbox"/> Bazooka Tube operation</p>	<p>Radio display turns on &amp; sound is heard</p> <p>CD player functions &amp; Satellite Tuner stations are playing (if equipped)</p> <p>Reception of AM/FM stations</p> <p>Bazooka Tube – Listen to Bazooka Tube to make sure it is functioning properly or by feeling the Bazooka for vibration. Be sure the Phase Switch is in the “UP” position.</p>
<p><b><u>Vehicle Function Checks</u></b></p> <p><input type="checkbox"/> Hazard Button</p> <p><input type="checkbox"/> HVAC</p> <p><input type="checkbox"/> Rear Window Defogger</p> <p><input type="checkbox"/> Passenger Seat Belt Warning Light</p>	<p>Functioning Hazard Lights</p> <p>All HVAC controls function properly</p> <p>Functioning Rear Window Defogger</p> <p>Functioning Seat Belt Warning Light</p>

## **VEHICLE FUNCTION CHECK**

AFTER ALL PANELS, COVERS, AND COMPONENTS HAVE BEEN REINSTALLED, THAT WERE REMOVED, TEST THOROUGHLY, ALL MECHANICAL AND ELECTRICAL COMPONENTS DISCONNECTED AND OR REMOVED FROM THE VEHICLE DURING THE INSTALLATION OF THIS ACCESSORY.



Troubleshooting

Condition:

- No sound from Bass Tube, however factory speakers still play

- Distorted Sound

- Low Sound

- Rattling Noises

Check For:

1. Is the green L.E.D. lit on the Bass Tube? If not, check for 12 volts on pins of the Bass Tube Connector with the ignition on. If either pin doesn't indicate 12 volts, check T-Harness connectors behind the radio.

2. Is the 14-pin Molex connector securely connected to the Bass Tube?

3. Is the ground ring securely fastened to the rear center Anchorage bolt?

1. Close the back hatch of the vehicle

2. Adjust the radio to a comfortable listening level, and then turn the "gain control" knob on the Bass Tube counter-clockwise until the sound becomes clean.

1. Close the back hatch of the vehicle

2. Adjust the radio to a comfortable listening level, and then turn the "gain control" knob on the Bass Tube clockwise until the sound becomes audible. Do not adjust the level too high, as this will result in distorted sound.

Rattling will be evident in some panels at extreme volume conditions, but make sure you have performed the following to minimize noise:

1. Securely tightened Mounting Hardware so Bass Tube Bracket does not move.



Troubleshooting

Condition: \_\_\_\_\_

- Dimming Radio Lights
  
- Radio does not come on
  
- No Sound at all
  
  
  
  
  
  
  
  
  
  
- Bass Tube produces sound on the right or the left, but not both.

Check For: \_\_\_\_\_

Dimming Radio Lights could occur when the Bass Tube is played at high volumes.

Check to ensure that the main connector, antenna connector, and auxiliary connector have been correctly plugged back in.

1. Is the fuse under the hood still operational?
2. Is the battery ground reconnected?
3. Is the radio connector securely seated?

Check T-Harness connections at the back of the radio. All connectors must be securely fastened to the correct wiring for both channels to produce audio output.





Wire Harness & Radio Wiring Schematics

<b>WIRING CONNECTOR SCHEMATICS:</b>		
<b>Harness Split</b>	<b>Radio Connector</b>	<b>Subwoofer Connector</b>
<b>Harness Split Connector</b>		
<b>Pin No.</b>	<b>Wire Color</b>	<b>Function</b>
1	Red	12 Volt Battery Connection (B+)
2	White/Black	Left Front Speaker (-)
3	Gray/Black	Right Front Speaker (-)
4	Blue/White	Remote Turn-On/Ignition (Switched+)
5	White	Left Front Speaker (+)
6	Gray	Right Front Speaker (+)
<b>Subwoofer Connector</b>		
<b>Pin No.</b>	<b>Wire Color</b>	<b>Function</b>
1	Black	Chassis Ground
2	N/A	N/A
3	N/A	N/A
4	N/A	N/A
5	White	Left Front Speaker (+)
6	Grey	Right Front Speaker (+)
7	N/A	N/A
8	Red	12 Volt Battery Connection (B+)
9	Blue/White	Remote Turn-On/Ignition (Switched+)
10	N/A	N/A
11	N/A	N/A
12	White/Black	Left Front Speaker (-)
13	Grey/Black	Right Front Speaker (-)
14	N/A	N/A
<b>Radio Connector (R4 GRAY)</b>		
<b>Pin No.</b>	<b>Wire Color</b>	<b>Function</b>
1		Right Front Speaker (+)
2		Left Front Speaker (+)
3	NO CONNECTION	NO CONNECTION
4	NO CONNECTION	NO CONNECTION
5		12 Volt Ignition Switched (B+)
6		12 Volt Battery Connection (B+)
7		Right Front Speaker (-)
8		Left Front Speaker (-)
9		Chassis Ground (B-)
10		Power Antenna Control (+)
11		Power Antenna Control (-)
12		Dimmer / Illumination Control (B+ variable)